

## Energy Certificates, CODE Assessments & Lighting Design

Welcome to the July News Bulletin from Thornley and Lumb Partnership Ltd providing you with company and industry updates.

Thornley and Lumb Partnership's Low Carbon Consultants and Energy Advisors can offer SBEM Calculations, Energy Performance Certificates (EPC's), Display Energy Certificates (DEC's) for all types of properties, BREEAM Assessments in Offices, Retail & Ecohomes as an addition to our already extensive portfolio of services. We can also offer Code for Sustainable Home Assessments which are now mandatory for all new homes in England

### Energy Certificates - Site Inspections & Data Gatherers

#### Site Inspections

Energy performance certificates are now required for all commercial buildings that are constructed, sold or let. Public buildings throughout England and Wales also need to display an energy certificate (similar legislation will also apply to Scotland and Northern Ireland).

Under the Department of Communities and Local Government (DCLG) guidelines all Energy Assessors have to carry out a site inspection to collect the data required to produce the Energy Performance Certificate. From the 1st July 2009 remote lodgement of Display Energy Certificates will also be regarded as unacceptable.

#### Data Gatherers

The following changes are to existing guidance and/or standards and should take effect from 1st April 2009 :-

Data gatherers are not permitted for level 3 properties

Data gatherers are permitted for level 4 and 5 in the following circumstances:

- Anyone collecting data for level 4 and 5 must be accredited to level 3 or provide documentary evidence that shows they are 'fit and proper' and qualified to undertake the work in hand.
- Any data gatherers used must work for the same company as the Energy Assessor.
- Energy Assessors must have ISO 9001 procedures in place and supervise the data gatherers in their employment and on site.

The Energy Assessor is responsible for the quality of the data used for the certificate and the competence of any persons gathering data on their behalf.

Our Energy Assessors carry out the site inspection, data input to the software and lodgement of the certificate.

### Code for Sustainable Homes

In April 2007 the Code for Sustainable Homes replaced Ecohomes for the assessment of new housing in England. The Code is an environmental assessment method for new homes based upon BRE's Ecohomes and contains mandatory performance levels in 7 key areas.

The Code aims to protect the environment by providing guidance on the construction of high performance homes built with sustainability in mind.

#### The Scope of the Code

Many house builders who currently use Ecohomes will find the credit system of the Code familiar. Users will notice that there are new mandatory minimum levels of performance that have been introduced across 7 key issues:

- Energy efficiency /CO<sub>2</sub>
- Water efficiency
- Surface water management
- Site Waste Management
- Household Waste Management
- Use of Materials
- Lifetime homes (applies to Code Level 6 only)

#### The Code Scoring System

The Code has a scoring system of six levels. The different levels are made up by achieving both the appropriate mandatory minimum standards together with a proportion of the 'flexible' standards.

#### Compliance with the Code

Code assessments are carried out in two phases:

- An initial assessment and interim certification is carried out at the design stage design drawings, specifications and commitments Results in interim certificate of compliance
- Final assessment and certification is carried out After construction Based on the design stage Review. Confirmation of compliance including site records & visual inspection.

### Mechanical & Electrical Building Services Consultant Engineers



## Energy Certificates, CODE Assessments & Lighting Design

### Lighting Design

Lighting has the ability to completely transform the environment around us, therefore at Thornley & Lumb we place great emphasis on high quality and imaginative lighting solutions for our clients. Without ties to one particular lighting supplier we can draw on the latest lamp, luminaire & controls technology to achieve the best possible end results with a full and unbiased lighting design service.

We have extensive experience with both interior and exterior lighting projects & can offer advice and assistance at the concept & planning application stages of your development.

From basic light level plots for engineering projects through to fully raytraced presentation images with impressive realism for interior design and client approval we are able to assist.

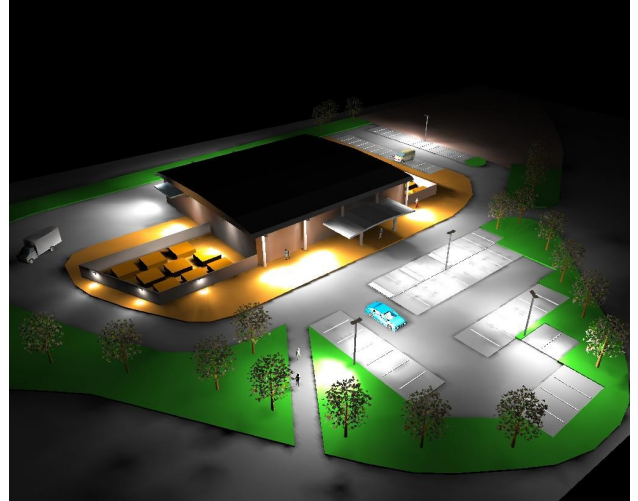

There are a couple of examples of images produced in house, further examples are on our website.



### Website

Visit our new look website with details of all our services, company news, industry news and information, details on Energy Performance Certificates, Display Energy Certificates etc...

[www.thornleylumb.co.uk](http://www.thornleylumb.co.uk)

You can now register online to receive our news bulletin

### Contact us

If you would like to discuss your requirements for any project please get in touch with our office on 01274 687755:

James Forster: BREEAM Offices  
Ecohomes  
The Code for Sustainable Homes  
SBEM Calculations  
EPC's & DEC's

Andrew Jagger: BREEAM Retail  
Ecohomes  
SBEM Calculations  
EPC's & DEC's

Alternatively please email any enquiries to:  
[energy@thornleylumb.co.uk](mailto:energy@thornleylumb.co.uk)

**Mechanical & Electrical Building Services Consultant Engineers**



**Thornley & Lumb**  
Mechanical & Electrical Consultant Engineers

**Thornley & Lumb Partnership**  
Century House  
257 Cutler Heights Lane  
Bradford, BD4 9JG  
Tel: 01274 687755  
Email: [energy@thornleylumb.co.uk](mailto:energy@thornleylumb.co.uk)

